

- ⋯ GreenWay Trail (GT) new route / bridge
- ⋯ GreenWay Trail upgrade existing / bridge
- ⋯ Associated local path or facility / bridge
- LR station location & ped crossing point
- Access to LR station / street connection
- Current established bushcare site
- Future bushcare site or existing (weeds dominant) habitat area
- Off-set bushcare site in conjunction with LR development

0 — 100m

Lilyfield Rd area

- reconfigured junction between Bay Run and GreenWay Trail, and route past UTS Rowers as per RTA study by The Environment Works Pty Ltd, Feb 2010
- conversion of Lilyfield Rd bridge area to 'shared zone'
- improved path connections E side of bridge down to Bay Run

Bridge crossing Hawthorne Canal

- integrate GreenWay Trail and bushcare works with proposed new bridge crossing of Hawthorne Canal being undertaken by Councils
- replace trash boom with point source traps

Saltmarsh demonstration area

- possible location for new off-line stepped-depth saltmarsh zone adjacent to Hawthorne canal sides
- relocation of asphalt basketball area to adjacent existing tennis courts
- possible location for stormwater drainage swale and/or raingarden
- walking/interpretive trail through revegetated site & alongside saltmarsh

GreenWay Trail Hawthorne Canal bridge to LilyField Rd

- upgrade 1035m of existing path through Richard Murden Reserve to 3m standard; use of low carbon emission, low heat gain/reflective path materials; install LED solar lighting
- provide 400m new path section adjacent to Hawthorne Canal to bypass play area and tennis courts
- establish shade tree planting along length of Trail section especially western side of pathway

Canal Rd LR Station

- potential location for light rail station adj. Canal Rd (@1.16km) including secure bicycle parking
- alternate LR station 150m east (@0.95km) including lift to James St. Design should include room for any future Trail connection to Anzac Bridge through tunnel but outside of dual tracks
- improved path connections and ramp for existing pedestrian overbridge across City West Link Rd
- link to bi-directional bike lane Darley Rd
- traffic-calmed entry section to Canal Rd

Darley Rd & Cafe Bones area

- possible location for signalised crossing point of rail corridor vicinity Cafe Bones to connect to Canal Rd and Darley Rd
- construct 3m wide bi-directional cycle lane (+barrier) on W/City-bound side of Darley Rd between Allen St and Canal Rd
- construct 200m shared pathway through park adj. Allen St to connect through new cyclist/only subway under railway
- establish bushcare corridor E side of corridor Canal Rd to Allen St, including Darley Rd road reserve north of Shields Playground

GreenWay Trail/cycleway, LR station Allen St

- potential location LR station adj. Allen St (@1.95km)
- replace existing pedestrian bridge on Hawthorne Canal
- provide new cyclist-only bridging, 200m of decking cycleway and crossing point at LR station to bypass existing Allen St subway and connect to a Darley Rd bi-directional cycle lane
- provide fencing and swing gate to separate off-leash dog area from shared pathways (on-lead only).
- establish community bushcare site at Loftus St, possibly requiring site decontamination and remediation

GreenWay Trail North of Marion St

- construct 320m of new shared pathway on western side of rail corridor located between tracks and Council depot. Establish shade trees W side of path
- provide new landscaped pedestrian link in rail corridor from Marion St to Walter St
- new revegetation establishment in conjunction with pathway including 30m width at end of Council depot in association with LMC

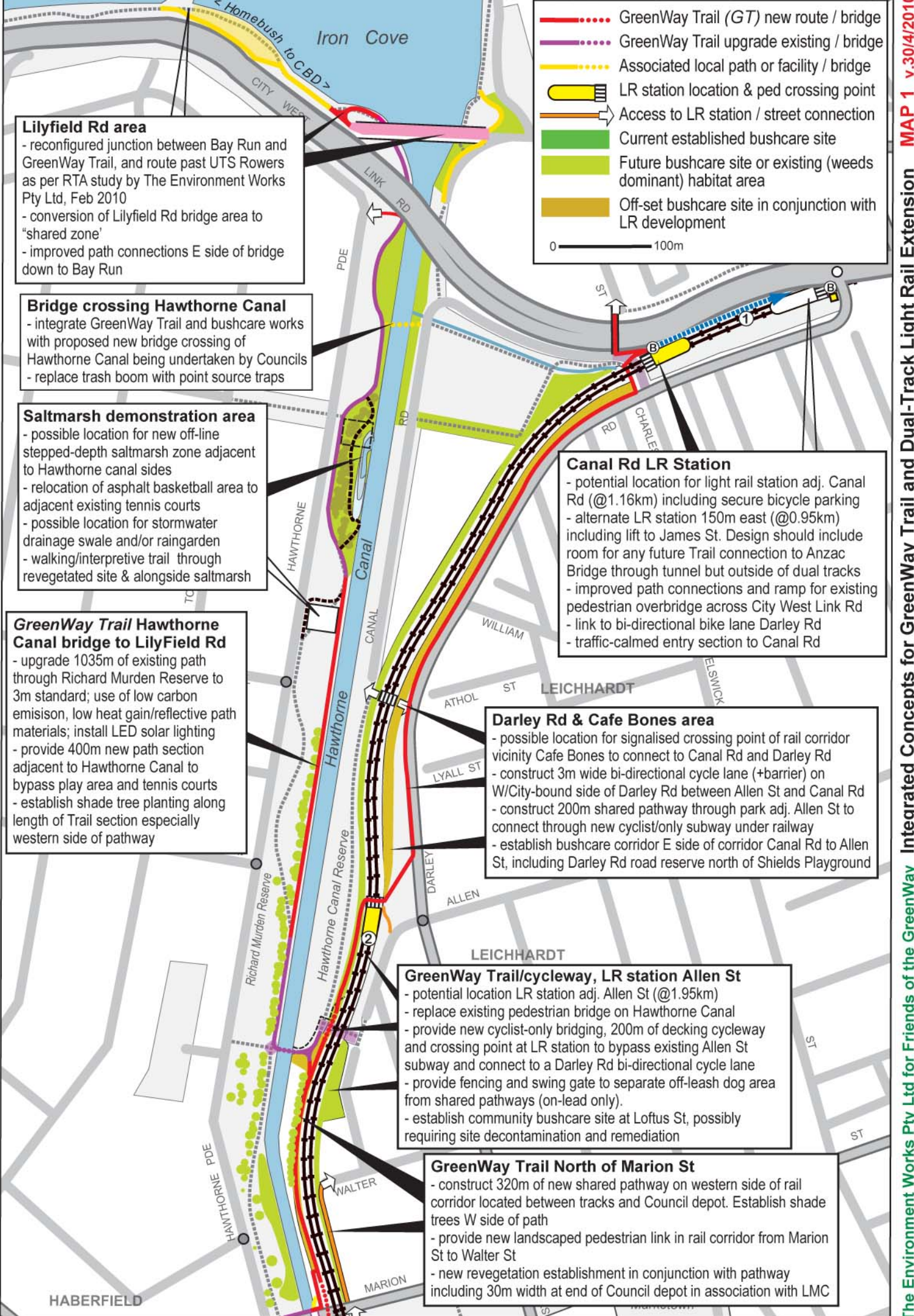

- GreenWay Trail (GT) new route / bridge
- GreenWay Trail upgrade existing / bridge
- Associated local path or facility / bridge
- LR station location & ped crossing point
- Access to LR station / street connection
- Current established bushcare site
- Future bushcare site or existing (weeds dominant) habitat area
- Off-set bushcare site in conjunction with LR development

0 ————— 100m

Marion St Light Rail station, GreenWay Trail Marion St to Parramatta Rd

- refuge crossing relocated 30m W to provide RH turn lane to Hawthorne Pde restriction to single lane each direction
- new pedestrian bridge across Marion St west side of existing railway bridge, and ramp down to Nth side Marion St and link to *Trail* and LR station
- potential location for light rail station Sth side Marion St (@2.47km) inc. secure bicycle storage/parking; CCTV; ramp link to street level; lift from street level to platform; ped crossing sth end of platform
- upgrade of 600m existing path adjacent to Hawthorne Canal to 3m standard as for RMR and provide concrete root barriers as path edging
- expand Lords Rd bushcare site as resources permit
- possible LR station at Parramatta Rd (@3.05km) with ramped connections W side down to GreenWay Trail

GreenWay Trail Parramatta Rd to Longport St

- new pathway link under Parramatta Rd to connect existing pathways as per current Battle Bridge studies
- alternate crossing with new bridge over Parramatta Rd and decking pathway 320m to connect to Longport St subway on E side of Hawthorne Canal in conjunction with LR station if link under Parramatta Rd not feasible/possible
- link to include solar powered/passive lighting, CCTV, artworks, bandicoot way, landscaping and revegetation
- upgrade of existing path alongside Hawthorne Canal to 3m standard as per Richard Murden Reserve specifications
- new 50m long section of "minimesh" decking 3m shared pathway to connect to 40m of bridged decking structure to Longport St subway portal. Bridged structure possibly supported from heritage-listed Whipple Truss(es)

Summer Hil Flour Mill LR station; GreenWay Trail Longport St to Old Canterbury Rd

- subway under Longport St, 30m x 3 x 4m, including solar powered/passive lighting, CCTV, artworks, bandicoot way
- path ramped link to Longport St from GreenWay Trail
- 3m shared pathway 120m from Longport St-Hawthorne Canal on decking, with native grasses in track area
- 180m of shared path with concrete edge to Old Canterbury Rd subway specifications as per RMR
- potential LR station location (@3.57km) with access to Hudson St and link to Smith St
- secure bicycle parking and lockers at LR station
- bush corridor established as part of LR and adjacent residential development

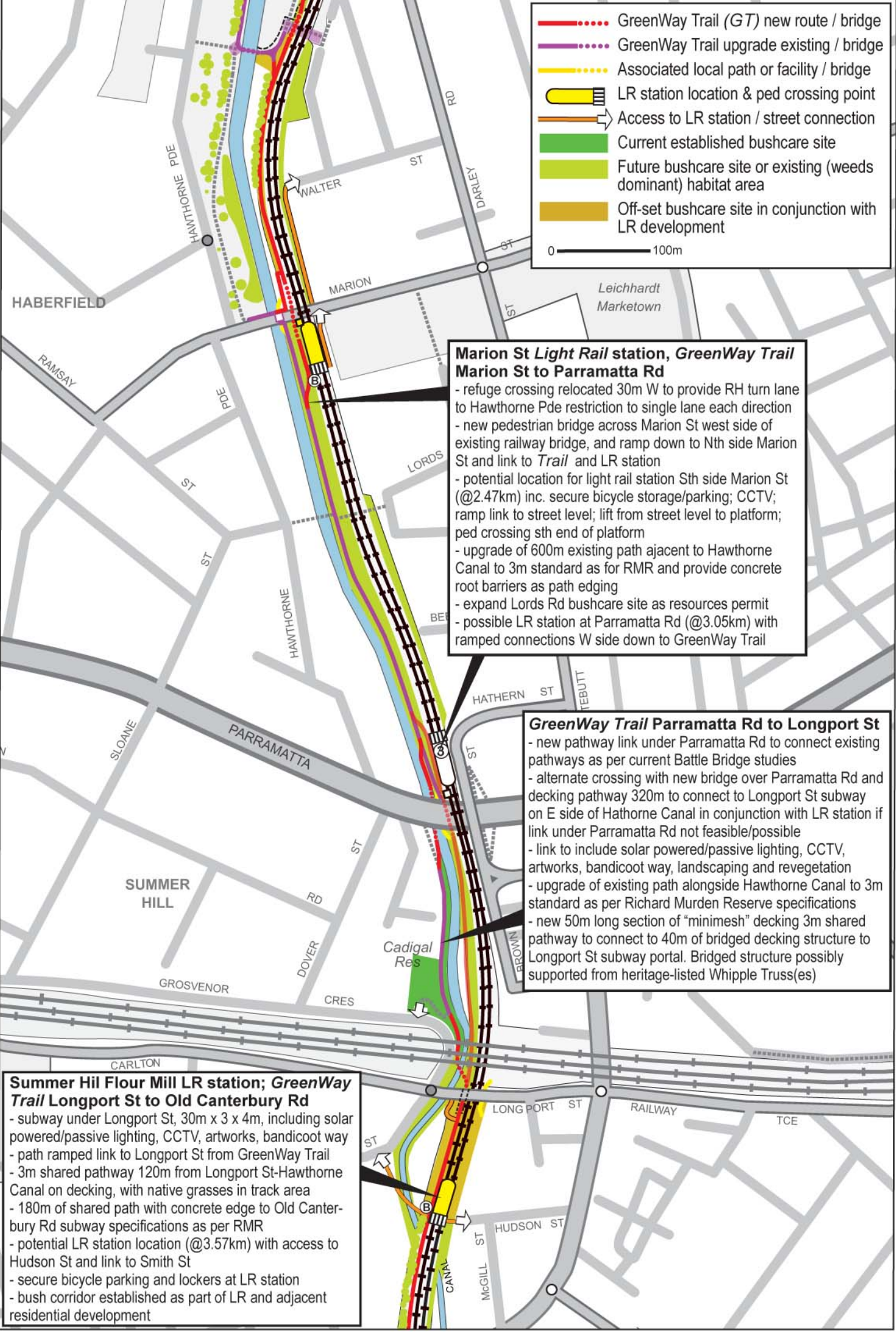

- · · · · · GreenWay Trail (GT) new route / bridge
- · · · · · GreenWay Trail upgrade existing / bridge
- · · · · · Associated local path or facility / bridge
- LR station location & ped crossing point
- Access to LR station / street connection
- Current established bushcare site
- Future bushcare site or existing (weeds dominant) habitat area
- Off-set bushcare site in conjunction with LR development

0 ————— 100m

Weston St GreenWay Trail route

- subway under Old Canterbury Rd, 40m x 3 x 4m and link to Weston St via cul de sac
- traffic calming Weston St for on-road section inc. road closure (cycling-permeable) at Weston St between Sydney Water site and Edward La; low speed zone at entry from Old Canterbury Rd and Windsor Rd
- upgrade footpaths as Trail pedestrian route

Old Canterbury Rd bushcare site

- establish site as high priority under existing programs in conjunction with Lewisham PS and Petersham PS
- isolate site from LR and GT construction and operational activity
- establish corridor maintenance and vegetation clearance protocol in conjunction with bush corridor objectives

Waratah Mills bushcare site

- isolate bushcare site from LR and Trail construction and operational activity
- establish RailCorp maintenance and vegetation clearance protocol in conjunction with bush corridor objectives
- possibly create additional bushcare site in Johnson Park between rail corridor boundary and existing pathway, similarly to Cooks River Valley Garden at Tempe
- small mammal way under Constitution Rd connecting Waratah Mills and Williams Pde bushcare sites

Davis St Light Rail station, bushcare site & GreenWay Trail crossing

- construct subway under Davis St 40m x 3m x 4m. Subway to include solar powered/passive lighting, CCTV, artworks, bandicoot/small mammal way
- decking/fenced connection to Davis St for minimal impact on biodiversity
- LR station (@4.27km) clear of/fenced from existing bushcare site
- shielded LED solar lighting for station and pathway to reduce light spill
- pedestrian/cycleway crossing point 10m from nth end abutment wall to improve sighting distances

GreenWay Trail Davis St to Constitution Rd

- 445m of 3m wide fenced "minimesh" decking trail east side of corridor
- relocation of a single overhead wiring stanchion by about 2.0m
- possible relocation of cyclone boundary fence (within RailCorp land) 1.0m E
- provide pedestrian and cycle access to Hill St
- remove existing asbestos cable ducting Davis St to Hill St and remediate site
- undergrounding of cabling or relocation to other side of formation
- separation fencing/hedging between Trail/tracks (@3.0m from track centre)
- provision of LED solar, habitat-sensitive lighting into trail decking
- bushcare planting/revegetation for remainder of corridor width
- subway under Constitution Rd plus 40m decking/bridged structure to link to Constitution Rd at-grade, plus pedestrian/cyclist crossing at grade
- Constitution Rd to improve local and LR station access

GreenWay Trail Constitution Rd to Hercules St, New Canterbury Rd LR station

- 140m of 3m wide shared pathway top of embankment east side of corridor to Denison Rd (asphalt or similar)
- replace 3 x *E. globulus* trees on top of embankment with appropriate species
- 60m of Trial on decking down from Denison Rd to northern end of LR platform, and ped crossing to W side corridor
- LR station (@4.95km), inc. lift from Sth end to footpath level on Nth side of New Canterbury Rd; secure bicycle parking at top of access ramp; shielded LED solar lighting
- 170m of 3m wide fenced suspended decking path Denison Rd to Hercules St, passing under New Canterbury Rd (min 2.2m head clearance)
- ped/bike-priority raised threshold crossing at Hercules St
- 30m section of footpath upgrade Sth side Hercules St
- bushcare planting in remaining space in E side corridor

Williams Pde bushcare site (Area 4)

- isolate site from LR and GT construction and operational activity
- establish RailCorp maintenance and vegetation clearance protocol w.r.t rail maintenance and habitat/biodiversity values
- engage local community volunteers & develop bush corridor site as funding & resources allow

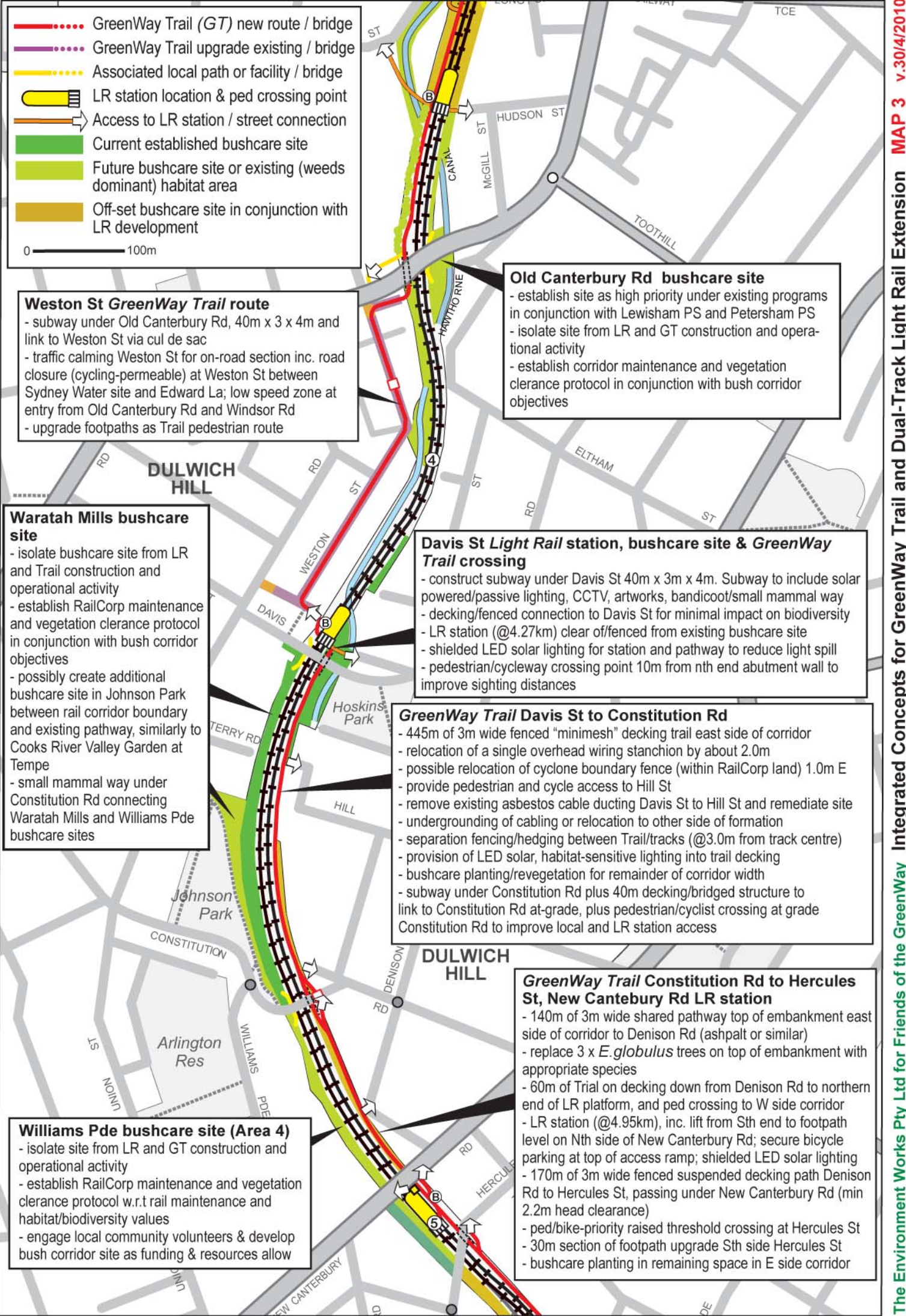

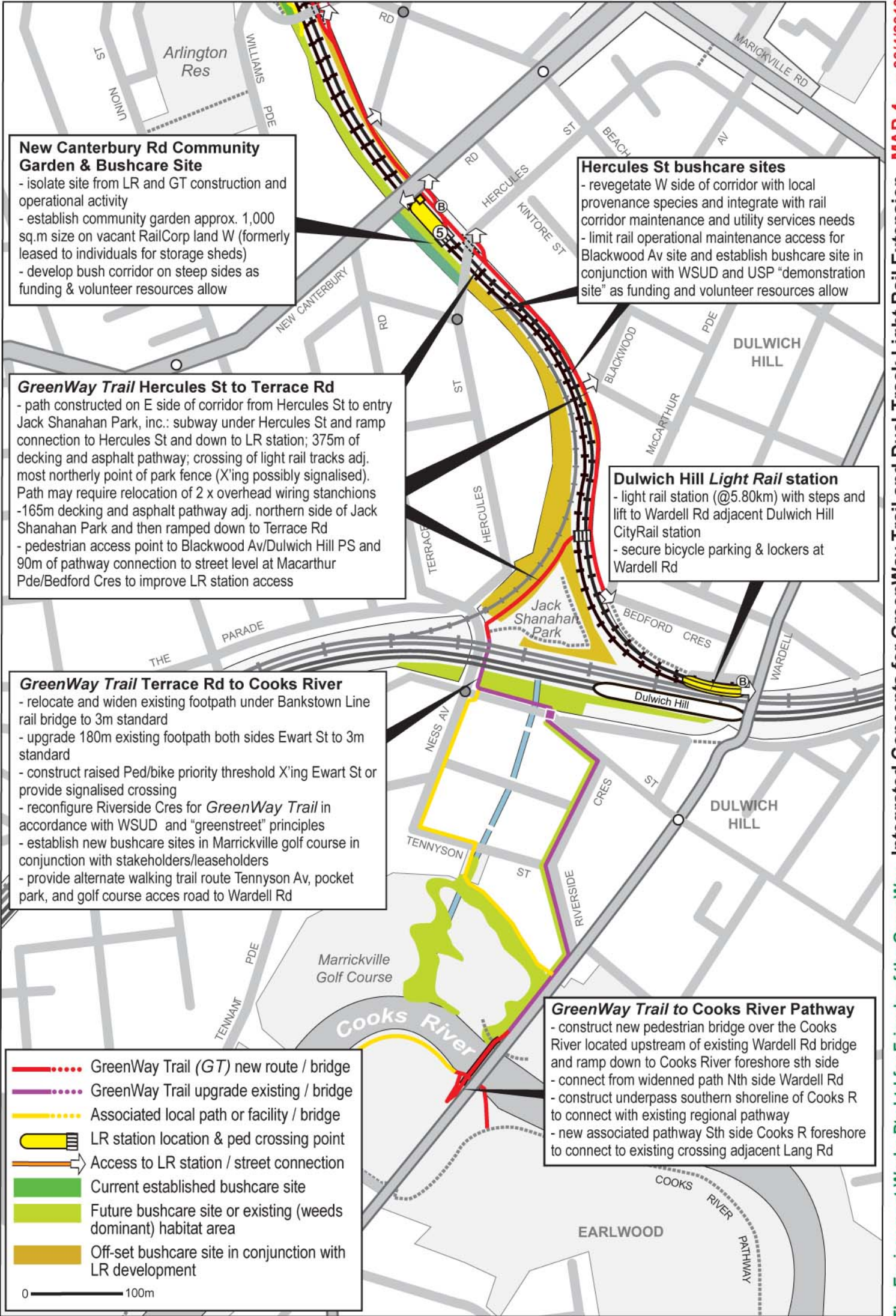

New Canterbury Rd Community Garden & Bushcare Site

- isolate site from LR and GT construction and operational activity
- establish community garden approx. 1,000 sq.m size on vacant RailCorp land W (formerly leased to individuals for storage sheds)
- develop bush corridor on steep sides as funding & volunteer resources allow

Hercules St bushcare sites

- revegetate W side of corridor with local provenance species and integrate with rail corridor maintenance and utility services needs
- limit rail operational maintenance access for Blackwood Av site and establish bushcare site in conjunction with WSUD and USP "demonstration site" as funding and volunteer resources allow

GreenWay Trail Hercules St to Terrace Rd

- path constructed on E side of corridor from Hercules St to entry Jack Shanahan Park, inc.: subway under Hercules St and ramp connection to Hercules St and down to LR station; 375m of decking and asphalt pathway; crossing of light rail tracks adj. most northerly point of park fence (X'ing possibly signalised).
- Path may require relocation of 2 x overhead wiring stanchions
- 165m decking and asphalt pathway adj. northern side of Jack Shanahan Park and then ramped down to Terrace Rd
- pedestrian access point to Blackwood Av/Dulwich Hill PS and 90m of pathway connection to street level at Macarthur Pde/Bedford Cres to improve LR station access

Dulwich Hill Light Rail station

- light rail station (@5.80km) with steps and lift to Wardell Rd adjacent Dulwich Hill CityRail station
- secure bicycle parking & lockers at Wardell Rd

GreenWay Trail Terrace Rd to Cooks River

- relocate and widen existing footpath under Bankstown Line rail bridge to 3m standard
- upgrade 180m existing footpath both sides Ewart St to 3m standard
- construct raised Ped/bike priority threshold X'ing Ewart St or provide signalised crossing
- reconfigure Riverside Cres for *GreenWay Trail* in accordance with WSUD and "greenstreet" principles
- establish new bushcare sites in Marrickville golf course in conjunction with stakeholders/leaseholders
- provide alternate walking trail route Tennyson Av, pocket park, and golf course acces road to Wardell Rd

GreenWay Trail to Cooks River Pathway

- construct new pedestrian bridge over the Cooks River located upstream of existing Wardell Rd bridge and ramp down to Cooks River foreshore sth side
- connect from widened path Nth side Wardell Rd
- construct underpass southern shoreline of Cooks R to connect with existing regional pathway
- new associated pathway Sth side Cooks R foreshore to connect to existing crossing adjacent Lang Rd

- GreenWay Trail (GT) new route / bridge
- GreenWay Trail upgrade existing / bridge
- Associated local path or facility / bridge
- LR station location & ped crossing point
- Access to LR station / street connection
- Current established bushcare site
- Future bushcare site or existing (weeds dominant) habitat area
- Off-set bushcare site in conjunction with LR development

0 — 100m